

REV	DESCRIPTION:	DATE
V0	新发行	2024.06.17

MECHANICAL OUTLINE, UNIT:mm  
(Unspecified Tolerances is: ±0.3 mm)

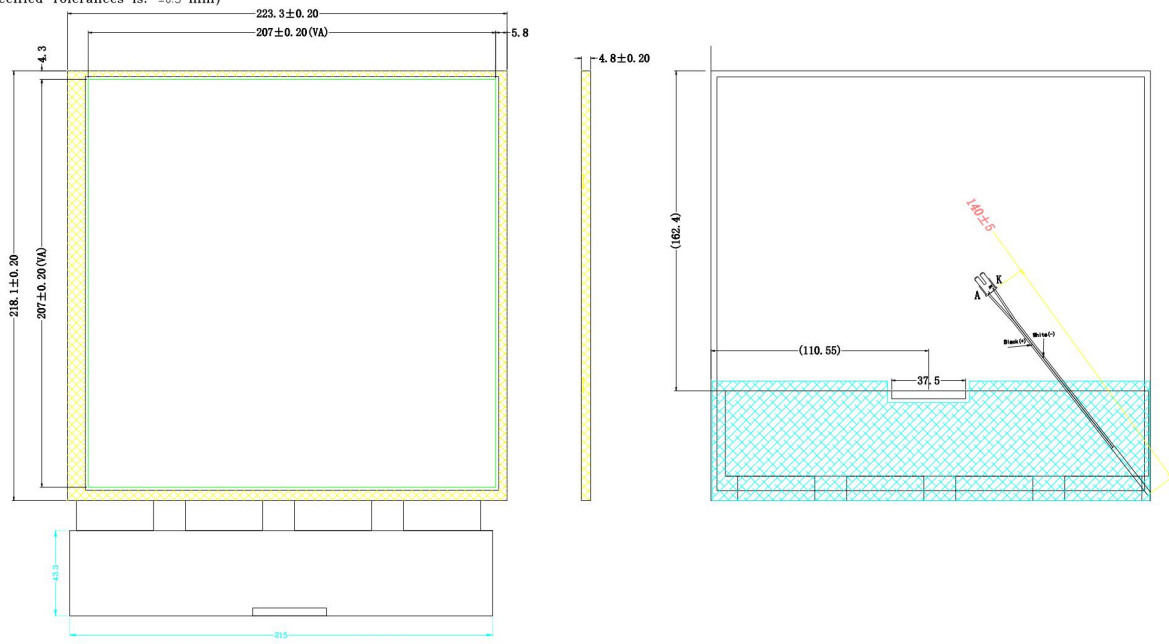

ELECTRICAL-OPTICAL CHARACTERISTICS  
(Ta=25°C. The Ambient temperature Ta=25°C)

Item	Symbol	Condition	min.	Typ.	max.	Unit
Forward Current	I <sub>f</sub>	mA				V
Reverse Current	I <sub>r</sub>	V				μA
Power dissipation	P <sub>d</sub>	mA			5.04	W
Colour Coordinates	γ	mA	1.00		1.00	
BL Luminance (Center Area)	L <sub>v</sub>	mA	--	--	--	cd/m <sup>2</sup>
Luminous Uniformity	U <sub>v</sub>	mA	70	75	--	%
LCM Luminance (reference**)	L <sub>v</sub>	mA	--	500	--	cd/m <sup>2</sup>
Operating Temperature Range	T <sub>op</sub>	normal use	-10		+60	°C
Storage Temperature Range	T <sub>stg</sub>	normal use	-20		+70	°C

PRODUCT NAME: 产品名称	CUST NUMBER: 客户编号	PROJECTION: 投影	SHEET: 图号 1 of 1	SCALE: 比例 1:1
			APPROVALS: 签字	DATE: 日期
			CHECK: 校对	
			APPROVE: 审核	